

Cancer Center Lower Level

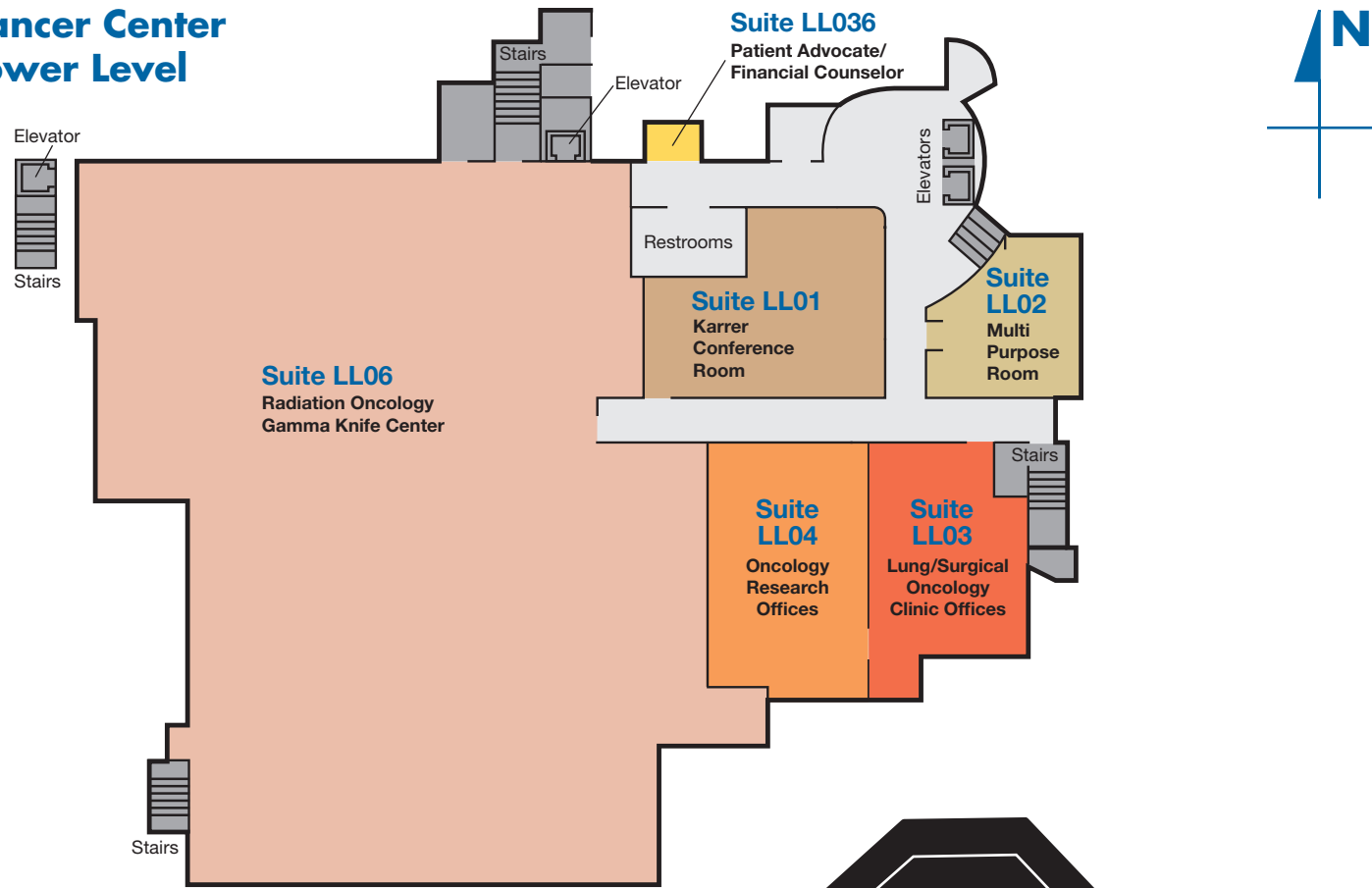

Cancer Center First Floor

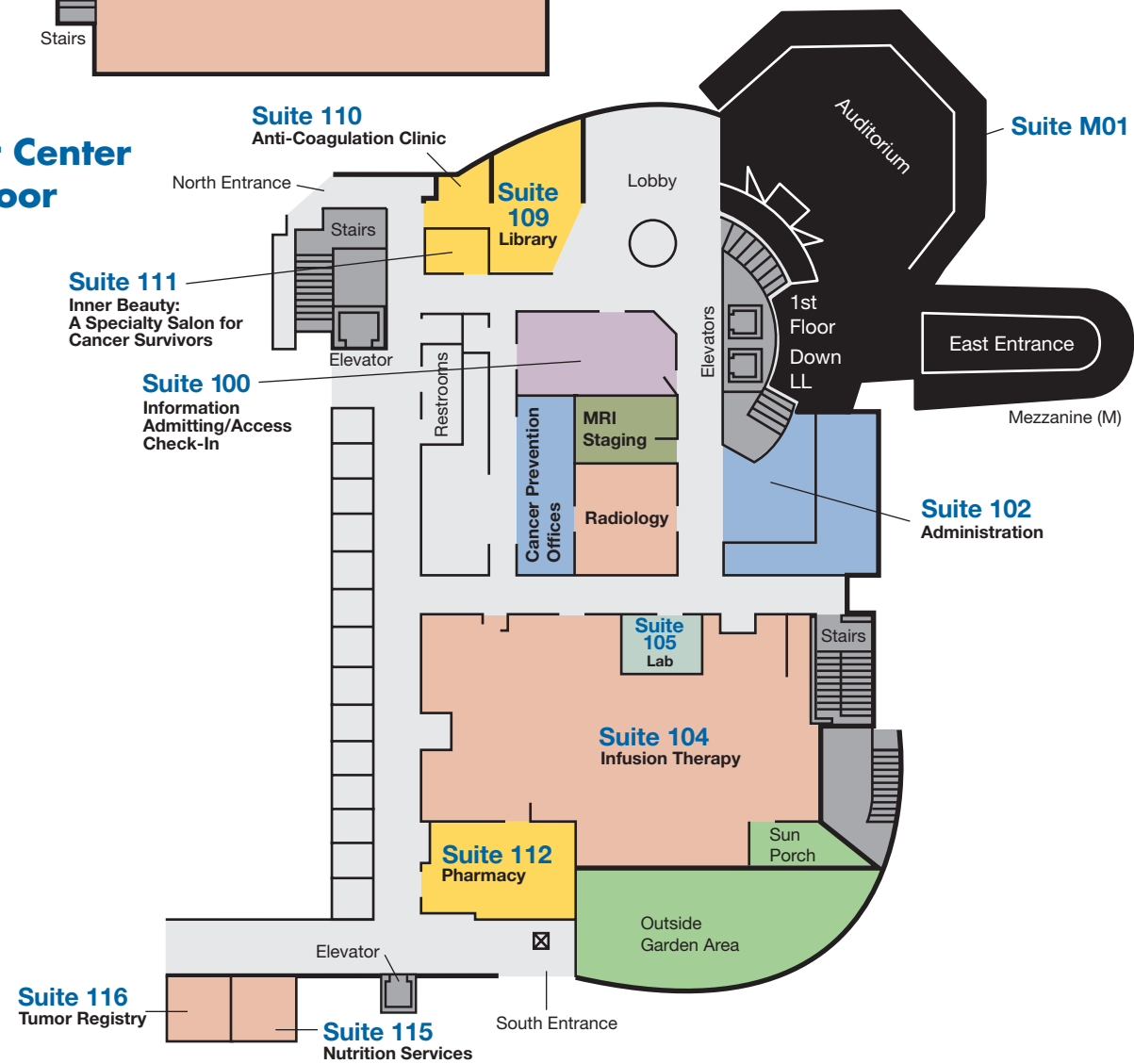

Cancer Center Second Floor

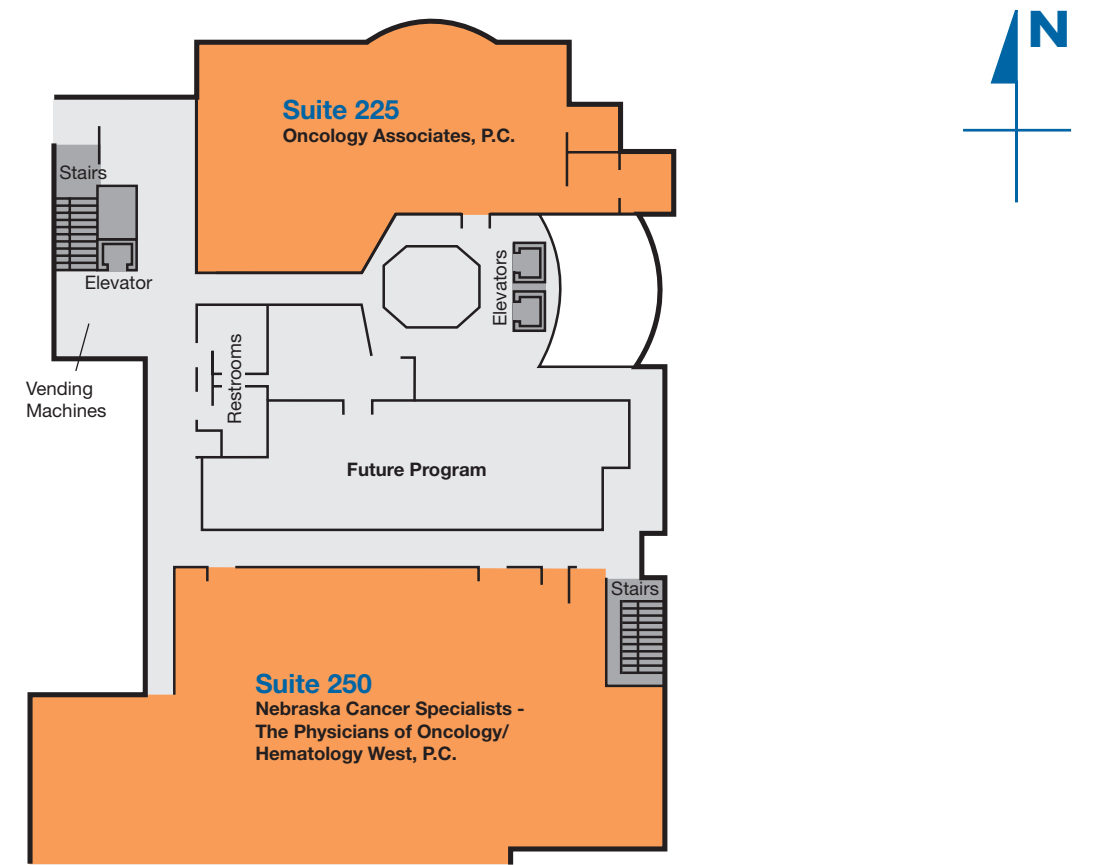

Cancer Center Third Floor

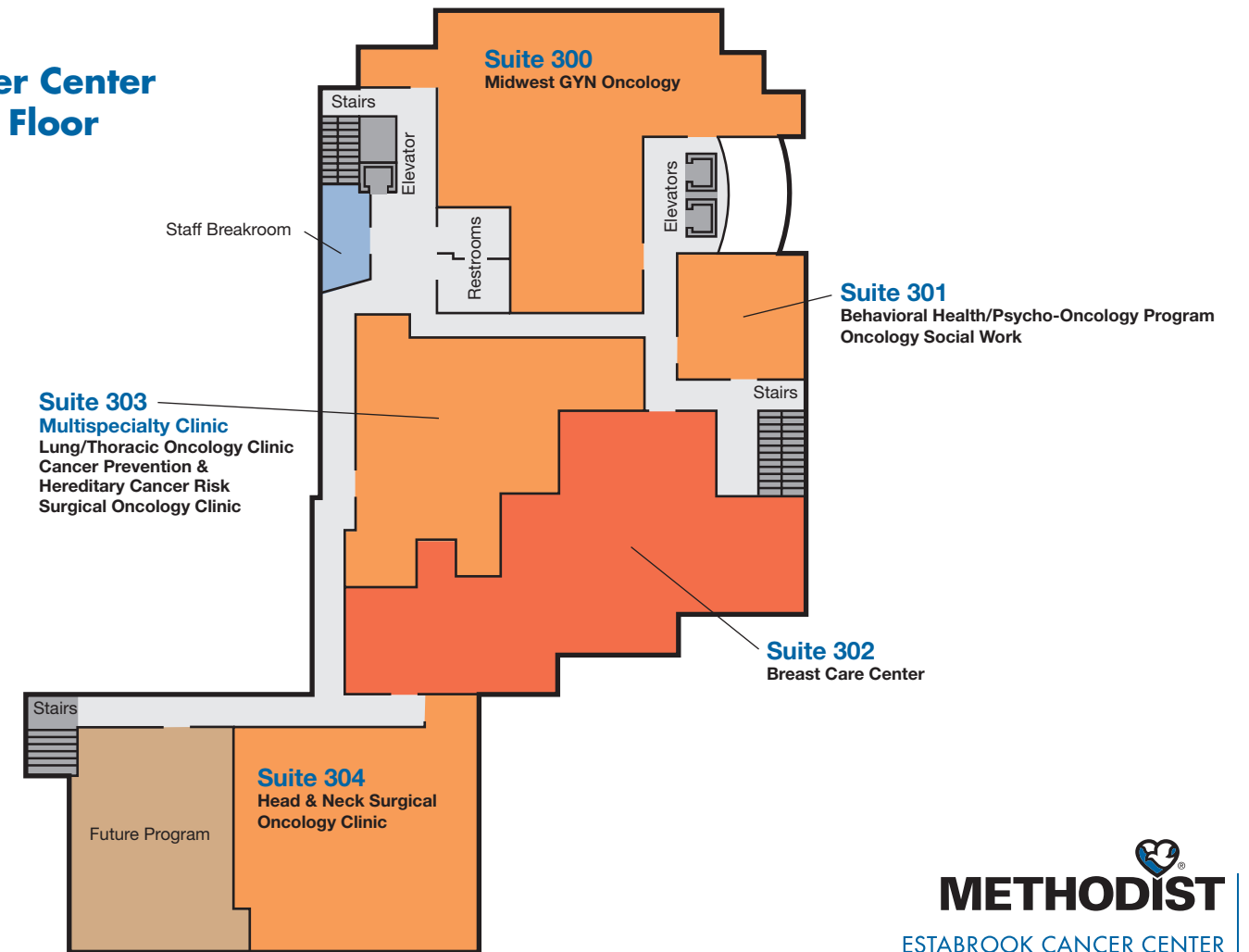



Map of the Estabrook Cancer Center



ESTABROOK CANCER CENTER

1 Visitor Parking Garage

Patient and visitor parking is available in the visitor parking garage located directly east of Methodist Hospital. From Dodge Street, access the main entrance by taking the lower drive in the front of Methodist Hospital.

2 Valet Parking

We encourage patients and visitors to use our valet parking. Free valet parking is available through a combination of valet stands and after-hours service from Security personnel. Tipping of valets is not required.

- Emergency Department: Valet stand operates 24/7 and is reserved for emergency room patients and their families.

- Main entrance: Valet stand operates on the upper drive of Methodist Hospital,

Monday through Friday from 7 a.m. – 5 p.m. After hours, call 4-4055 from a hospital phone to request assistance from Security.

- A valet stand is also available at Methodist Estabrook Cancer Center/ Outpatient Surgery Center, Monday through Friday from 7 a.m. – 5 p.m.

NOTE: We also recommend the use of valet parking to facilitate patient dismissals. Please remember to present your valet parking ticket to the nurse or patient escort so that your car can be waiting at the south entrance when you and/or your patient are ready to leave.

2 Patient/Visitor Pick-Up & Drop-Off

Methodist Hospital's upper drive is available for patient and visitor pick-up and drop-off. Please remember that the drive is a passenger loading zone only.

3 Emergency Department

The parking area located directly outside the Emergency Department on the north side of Methodist Hospital is a passenger loading zone only. Free valet parking is available for all visitors and patients.

4 Methodist Estabrook Cancer Center

Methodist Estabrook Cancer Center/Outpatient Surgery Center patients and visitors may use the 60-space parking lot on the south side of the Cancer Center or the visitor parking garage.

5 Patient/Visitor Parking Lot

Methodist Estabrook Cancer Center/ Outpatient Surgery Center patients and visitors may also use this self parking lot.

6 Employee Parking Garage

METHODIST

ESTABROOK CANCER CENTER

Location Guide

8303 Dodge Street, Omaha, NE 68114
(402) 354-5890
(South of Methodist Hospital)

